



# PUBLIC NOTICE

US Army Corps  
of Engineers  
Rock Island District

Applicant: Wendling Quarries

Date: January 14, 2021

Expires: February 12, 2021

CEMVR-RD-2020-1462

Section 404

---

**Joint Public Notice  
US Army Corps of Engineers  
Iowa Department of Natural Resources**

1. **Applicant:** Wendling Quarries, c/o: Mr. Morgan Schuler, P.O. Box 230, DeWitt, Iowa, 52742.
2. **Project Location:** Wetlands near the Wapsipinicon River and tributaries in Section 15, Township 80 North, Range 5 East, Clinton County Iowa. UTM NAD-83 Zone 15, Latitude 41.743833, Longitude -90.370239.
3. **Project Description:** The Applicant proposes to expand the existing Follets Sand Quarry by approximately 9.6 acres through mechanical excavation. To accomplish this, all overburden will be removed from the site and stockpiled in an upland, non-wetland location. Once the overburden is removed, the site will be mechanically excavated. The resulting sand pit will have 3:1 side slopes and will be approximately 40-feet deep. There will be 4-foot tall berms with 5-foot wide width surrounding the new pit. When complete, the expansion will connect with the existing sand quarry. This project will result in the unavoidable loss of approximately 2.02 acres of emergent wetland. To avoid additional wetlands present on-site, the Applicant has modified the design of the proposed expansion. To compensate for the loss of wetlands, the Applicant will purchase 2.02 acres of emergent wetland from an approved wetland mitigation bank in the service area of the impacts.
4. **Agency Review:**
  - a. Department of the Army, Corps of Engineers. The Department of the Army application is being processed Section 404 of the Clean Water Act (33 U.S.C. 1344).
  - b. State of Iowa. The project plans have been submitted to the Iowa Department of Natural Resources for state certification of the proposed work in accordance with Section 401 of the Clean Water Act. The certification, if issued, will express the Department's opinion that the proposed activity will comply with Iowa's water quality standards (Chapter 61 IAC). The applicant has also applied for authorization of work in the floodplain pursuant to Chapter 455B of the Iowa Code and other applicable state permits. Written comments concerning possible impacts to waters of Iowa should be addressed to: Iowa Department of Natural Resources, 502 East 9<sup>th</sup> Street, Des Moines, Iowa 50319. A copy of the comments should be provided to the Corps of Engineers office (see paragraph 11. of this public notice for address).

- 5. Historical/Archaeological:** The District consulted with the Iowa online geographic information systems archeological site and survey databases and determined the permit area has not been previously surveyed. Based on a review of historic and current aerial photos, topo maps, the HILD database, and the Culture Map, it is the opinion of the District Archaeologist the permit areas have the potential to contain historic properties that may be potentially eligible for listing on the National Register of Historic Places (NRHP). The District will require the applicant to submit two (2) copies of a Phase I archaeological survey and geomorphological evaluation report covering the permit area. Geomorphological investigation must extend at least 50 centimeters below the proposed depths of soil disturbance or to a depth below which no possibility of historic properties exists. The applicant, in addition to this Phase I report, may be required to conduct additional Phase II test excavations to evaluate sites for eligibility for inclusion in the NRHP as well as other studies, site avoidance, or data recovery as may be the case.
- 6. Endangered Species:** The proposed project will not affect any threatened or endangered species. Habitat for any of the listed species in Clinton County is not present on the site as it is a degraded emergent wetland dominated by reed canary grass.
- 7. Dredge/Fill Material Guidelines:** The evaluation of the impact of the proposed activity on the public interest will also include application of the guidelines promulgated by the Administrator of the United States Environmental Protection Agency under authority of Section 404(b) of the Clean Water Act (40 CFR Part 230).
- 8. Public Interest Review:** The decision whether to issue the Corps permit will be based on an evaluation of the probable impact including cumulative impacts of the proposed activity on the public interest. That decision will reflect the national concern for both protection and utilization of important resources. The benefit which reasonably may be expected to accrue from the proposal must be balanced against its reasonably foreseeable detriments. All factors which may be relevant to the proposal will be considered including the cumulative effects thereof; among those are conservation, economics, aesthetics, general environmental concerns, wetlands, cultural values, fish and wildlife values, flood hazards, floodplain values, land use, navigation, shoreline erosion and accretion, recreation, water supply and conservation, water quality, energy needs, safety, food production and, in general, the needs and welfare of the people.
- 9. Who Should Reply:** The Corps of Engineers is soliciting comments from the public; Federal, state, and local agencies and officials; Indian Tribes; and other interested parties in order to consider and evaluate the impacts of this proposed activity. Any comments received will be considered by the Corps of Engineers to determine whether to issue, modify, condition or deny a permit for this proposal. To make this decision, comments are used to assess impacts on endangered species, historic properties, water quality, general environmental effects, and the other public interest factors listed above. Comments are used in the preparation of an Environmental Assessment and/or an Environmental Impact Statement pursuant to the National Environmental Policy Act. Comments are also used to determine the need for a public hearing and to determine the overall public interest of the proposed activity. These statements should be submitted on or before the expiration date specified at the top of page 1. These statements should bear upon the adequacy of plans and suitability of locations and should, if appropriate, suggest any changes considered desirable.

10. **Public Hearing Requests:** Any person may request, in writing, within the comment period specified in this notice, that a public hearing be held to consider this application. Requests for public hearings shall state, with particularity, the reasons for holding a public hearing. A request may be denied if substantive reasons for holding a hearing are not provided.

11. **Reply to the Corps.** Comments concerning the Corps permit should be addressed to the District Engineer, US Army Corps of Engineers, Rock Island District, ATTN: Albert Frohlich RD-W, Clock Tower Building - Post Office Box 2004, Rock Island, Illinois 61204-2004. **Mr. Albert Frohlich** (309/794-5859) email: [Albert.J.Frohlich@usace.army.mil](mailto:Albert.J.Frohlich@usace.army.mil), may be contacted for additional information.



Attach  
Plan

Mr. Albert J. Frohlich  
Project Manager, Western Branch  
Regulatory Division

**REQUEST TO POSTMASTERS:** Please post this notice conspicuously and continuously until the expiration date specified at the top of page 1.

**NOTICE TO EDITORS:** This notice is provided as background information for your use in formatting news stories. This notice is not a contract for classified display advertising.

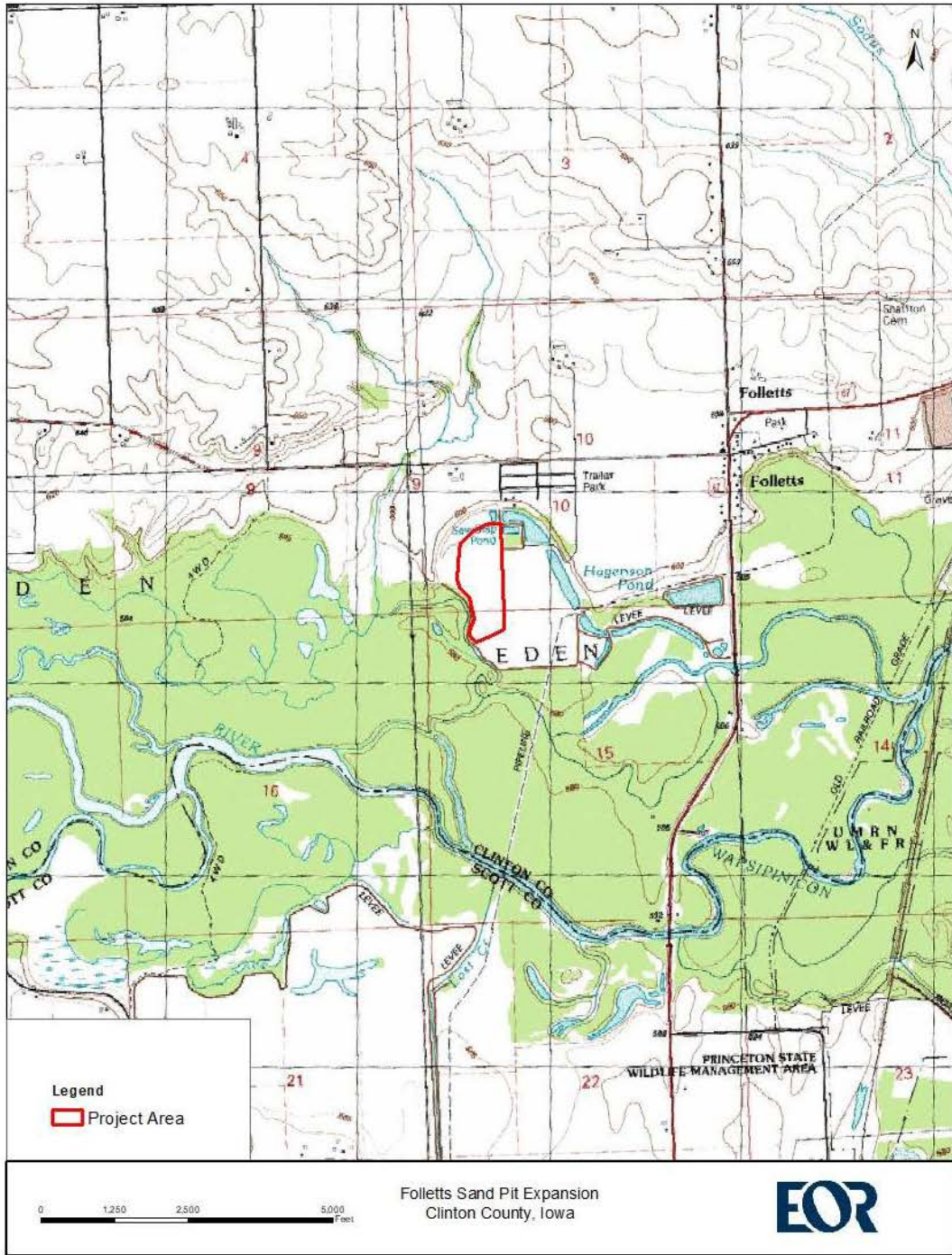

Figure 2. Project Overview Map.

CEMVR-RD-2020-1462  
 Sheet 1 of 4  
 Project Location



CEMVR-RD-2020-1462  
 Sheet 2 of 4  
 Wetland Impacts

DRAWN BY:	JGZ			
CHECKED BY:	LMI			
APPROVED BY:	---			
DATE:	12-14-2020			
FIELD BOOK:	XXX	NO.		

City of Folletts, Iowa

HALL & HALL ENGINEERS, INC.  
 2002 1st Street, Iowa City, IA 52242  
 (319) 335-1100  
  
 CIVIL ENGINEERING LANDSCAPE ARCHITECTURE  
 LAND SURVEYING AND DEVELOPMENT CONSULTING

WENDLING FOLLETT'S SANDPIT  
 IN THE CITY OF FOLLETT'S  
 CLINTON COUNTY, IOWA

WETLAND DISTURBANCE LIMITS

SHEET  
 EXH 4  
 PROJECT NO: 20246-4

CAD FILE: I:\projects\2020\CEMVR-RD-2020-1462-4\working\1462-4\wetting\1462-4\001\mxd\1462-4-001.dwg (Plot Date: 12/14/2020 3:13:38 PM)



CEMVR-RD-2020-1462  
 Sheet 3 of 4  
 Site Overview

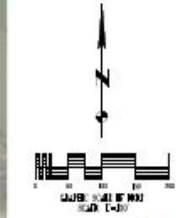

DRAWN BY: JGS					
CHECKED BY: LMH					
APPROVED BY: ---					
DATE: 12-14-2020					
FIELD BOOK: XXX	NO.	REVISION DESCRIPTION	APPROVED	DATE	

City of Follett, Iowa

HALL & HALL ENGINEERS, INC.  
 200 E. UNIVERSITY AVENUE, SUITE 200  
 IOWA CITY, IOWA 52242  
 319.336.8800  
 www.halleh.com

WENDLING FOLLETT'S SANDPIT  
 IN THE CITY OF FOLLETT  
 CLINTON COUNTY, IOWA

SITE OVERVIEW PLAN

CAD FILE: C:\projects\2020\1462\1462\_03\_Site Overview.dwg  
 DATE: 12/14/2020 10:00 AM  
 DRAWN BY: JGS  
 CHECKED BY: LMH  
 APPROVED BY: ---  
 DATE: 12-14-2020  
 FIELD BOOK: XXX  
 NO.

CEMVR-RD-2020-1462  
 Sheet 4 of 4  
 Cross Sections

### SECTION A-A

HORIZONTAL SCALE: 1" = 100'  
 VERTICAL SCALE: 1" = 10'

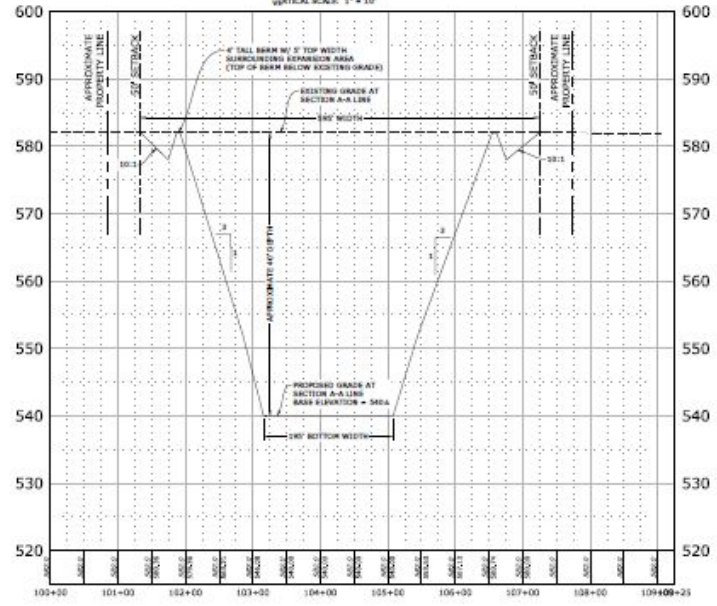

### SECTION B-B

HORIZONTAL SCALE: 1" = 100'  
 VERTICAL SCALE: 1" = 10'

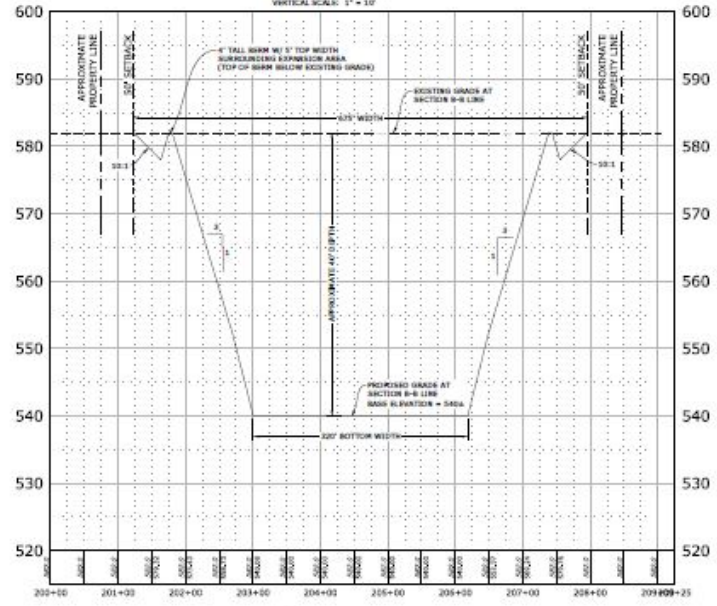

WENDLING FOLLETT'S SANDPIT  
 IN THE CITY OF FOLLETT'S  
 CLINTON COUNTY, IOWA

SECTION VIEW

SHEET  
 EXH 3

PROJECT NO. 23346-4

C:\Users\jgarcia\OneDrive\Documents\2020\2020-1462\Cross Sections\SECTION A-A.dwg, Date: 11/20/20, 1:23pm, Drawn By: JGARCIA